



Automotive Data Solutions Inc.

INSTALL GUIDE FLCART(DL)-CH6-EN

AVAILABLE FOR: FLCART

Rev. Date: January 03, 2018

Doc. No.: ##46825##

U.S. PATENT NO. 8,856,780

PLEASE VISIT WWW.FLASHLOGIC.COM FOR COMPLETE PRODUCT DETAILS

The brand names and logos found in this guide are property of their respective owners. Automotive Data Solutions Inc. © 2018

CHRYSLER DODGE

Jeep



RAM

TERMS OF USE: Automotive Data Solutions Inc. ("ADS") products are strictly intended for installation by Certified Technicians who are employed by a registered business specialized in the installation of automotive aftermarket electronics products. Prior to beginning installation of an ADS product in a vehicle, it is the Certified Technician's responsibility to review the most current Product Guide, Install Guide and vehicle-specific notes available in Weblink®. ADS is not responsible for any damages whatsoever, including but not limited to any consequential damages, incidental damages, damages for loss of time, loss of earnings, loss of profit, commercial loss, loss of economic opportunity and the like that may or may not have resulted from the use, misuse, improper installation or operation of its products. ADS reserves itself the right to suspend any Weblink® account without notice and decline to offer technical support to non-Certified Technicians, non-compliant Certified Technicians or end users.

INSTALL TYPE SELECTION

MAKE	MODEL	YEAR	INSTALL TYPE	FEATURES																	
				DATA IMMOBILIZER BYPASS	DOWNLOADABLE SOFTWARE	RS232 COMMUNICATION	2-WAY COMPATIBILITY	PRIORITY UNLOCK	DOOR LOCK	DOOR UNLOCK	ARM OEM ALARM	DISARM OEM ALARM	POWER LIFTGATE	TRUNK/HATCH RELEASE	POWER SLIDING DOOR (L)	POWER SLIDING DOOR (R)	DOOR STAT OUTPUT	TRUNK STAT OUTPUT	TACHOMETER OUTPUT	DATA/MUX STARTER CTRL	BRAKE PEDAL STAT OUTPUT*
CHRYSLER	300M	99-04	1	•	•	•	•	•	•	•	•	•	•	•	•	•	•	•	•	•	•
	300M w/Alarm	99-04	3	•	•	•	•	•	•	•	•	•	•	•	•	•	•	•	•	•	•
	Concorde	99-04	1	•	•	•	•	•	•	•	•	•	•	•	•	•	•	•	•	•	•
	Concorde w/Alarm	99-04	3	•	•	•	•	•	•	•	•	•	•	•	•	•	•	•	•	•	•
	LHS	99-01	1	•	•	•	•	•	•	•	•	•	•	•	•	•	•	•	•	•	•
	LHS w/Alarm	99-01	3	•	•	•	•	•	•	•	•	•	•	•	•	•	•	•	•	•	•
	Neon	00-05	3	•	•	•	•	•	•	•	•	•	•	•	•	•	•	•	•	•	•
	Pacifica	04-08	2	•	•	•	•	•	•	•	•	•	•	•	•	•	•	•	•	•	•
	PT Cruiser	01-05	3	•	•	•	•	•	•	•	•	•	•	•	•	•	•	•	•	•	•
	Sebring Sedan/Convertible	01-06	1	•	•	•	•	•	•	•	•	•	•	•	•	•	•	•	•	•	•
	Sebring Sedan/Convertible w/Alarm	01-06	3	•	•	•	•	•	•	•	•	•	•	•	•	•	•	•	•	•	•
	Town & Country	01-03	4	•	•	•	•	•	•	•	•	•	•	•	•	•	•	•	•	•	•
	Town & Country w/Alarm	01-03	5	•	•	•	•	•	•	•	•	•	•	•	•	•	•	•	•	•	•
	Town & Country	04-07	2	•	•	•	•	•	•	•	•	•	•	•	•	•	•	•	•	•	•
	Voyager	01-03	4	•	•	•	•	•	•	•	•	•	•	•	•	•	•	•	•	•	•
Voyager w/Alarm	01-03	5	•	•	•	•	•	•	•	•	•	•	•	•	•	•	•	•	•	•	
DODGE	Caravan/Grand Caravan	01-03	4	•	•	•	•	•	•	•	•	•	•	•	•	•	•	•	•	•	•
	Caravan/Grand Caravan w/Alarm	01-03	5	•	•	•	•	•	•	•	•	•	•	•	•	•	•	•	•	•	•
	Caravan/Grand Caravan	04-07	2	•	•	•	•	•	•	•	•	•	•	•	•	•	•	•	•	•	•
	Dakota	01-04	6	•	•	•	•	•	•	•	•	•	•	•	•	•	•	•	•	•	•
	Dakota w/Alarm	01-04	3	•	•	•	•	•	•	•	•	•	•	•	•	•	•	•	•	•	•
	Durango	01-03	6	•	•	•	•	•	•	•	•	•	•	•	•	•	•	•	•	•	•
	Durango w/Alarm	01-03	3	•	•	•	•	•	•	•	•	•	•	•	•	•	•	•	•	•	•
	Intrepid	99-04	1	•	•	•	•	•	•	•	•	•	•	•	•	•	•	•	•	•	•
	Intrepid w/Alarm	99-04	3	•	•	•	•	•	•	•	•	•	•	•	•	•	•	•	•	•	•
	Ram Pickup	02-05	3	•	•	•	•	•	•	•	•	•	•	•	•	•	•	•	•	•	•
	SRT 4	03-05	3	•	•	•	•	•	•	•	•	•	•	•	•	•	•	•	•	•	•
	Stratus Sedan	01-06	1	•	•	•	•	•	•	•	•	•	•	•	•	•	•	•	•	•	•
	Stratus Sedan w/Alarm	01-06	3	•	•	•	•	•	•	•	•	•	•	•	•	•	•	•	•	•	•
SX 2.0	03-05	3	•	•	•	•	•	•	•	•	•	•	•	•	•	•	•	•	•	•	
JEEP	Grand Cherokee	99-04	1	•	•	•	•	•	•	•	•	•	•	•	•	•	•	•	•	•	•
	Liberty	02-04	3	•	•	•	•	•	•	•	•	•	•	•	•	•	•	•	•	•	•
	Liberty	05-07	2	•	•	•	•	•	•	•	•	•	•	•	•	•	•	•	•	•	•
	TJ	01-06	1	•	•	•	•	•	•	•	•	•	•	•	•	•	•	•	•	•	•
	Wrangler	01-06	1	•	•	•	•	•	•	•	•	•	•	•	•	•	•	•	•	•	•
PLYMOUTH	Neon	00-01	3	•	•	•	•	•	•	•	•	•	•	•	•	•	•	•	•	•	•

Visit our website for advanced features.

† Extra resistor and relay required.

* Brake output available ONLY with ignition ON.

DETECT OEM ALARM EQUIPPED VEHICLES

WITH OEM KEYFOB

WITHOUT OEM KEYFOB

1 Close hood and trunk/hatch.
Enter vehicle.
Close all doors.

1 Open driver's door window.
Close hood and trunk/hatch.
Close all doors.

2 Press LOCK twice on OEM fob.



Wait 60 seconds.

2 LOCK driver's door twice using OEM key.

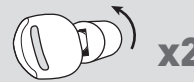

Wait 60 seconds.

3 Open driver's door.

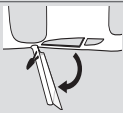

Alarm goes on,
OEM alarm equipped vehicle.

3 Open driver's door using handle located inside vehicle.

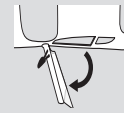

Alarm goes on,
OEM alarm equipped vehicle.

TYPE 1 - WIRE CROSS REFERENCE CHART - 1 OF 1

MAKE	MODEL	YEAR	IGNITION		J1850	
			WIRE COLOR	POSITION	WIRE COLOR	POSITION
CHRYSLER	300M ²	99-04	Blue/White	4	Violet/Yellow	2
	Concorde ²	99-04	Blue/White	4	Violet/Yellow	2
	LHS ²	99-01	Blue/White	4	Violet/Yellow	2
	Sebring Sedan/Convertible ²	01-06	Blue/White	4	Violet/Pink	2
DODGE	Intrepid ²	99-04	Blue/White	4	Violet/Yellow	2
	Stratus Sedan ²	01-06	Blue/White	4	Violet/Pink	2
JEEP	Grand Cherokee ^{1&2}	99-04	Blue/White	3	Yellow/Violet or Yellow/Black	5
	TJ ^{1&2}	01-04	Blue	4	Violet/Yellow	2
	TJ ^{1&2}	05-06	Pink/White	4	White/Violet	2
	Wrangler ^{1&2}	01-04	Blue	4	Violet/Yellow	2
	Wrangler ^{1&2}	05-06	Pink/White	4	White/Violet	2

¹ With OEM Alarm

² Without OEM Alarm

TYPE 1 - WIRING DIAGRAM

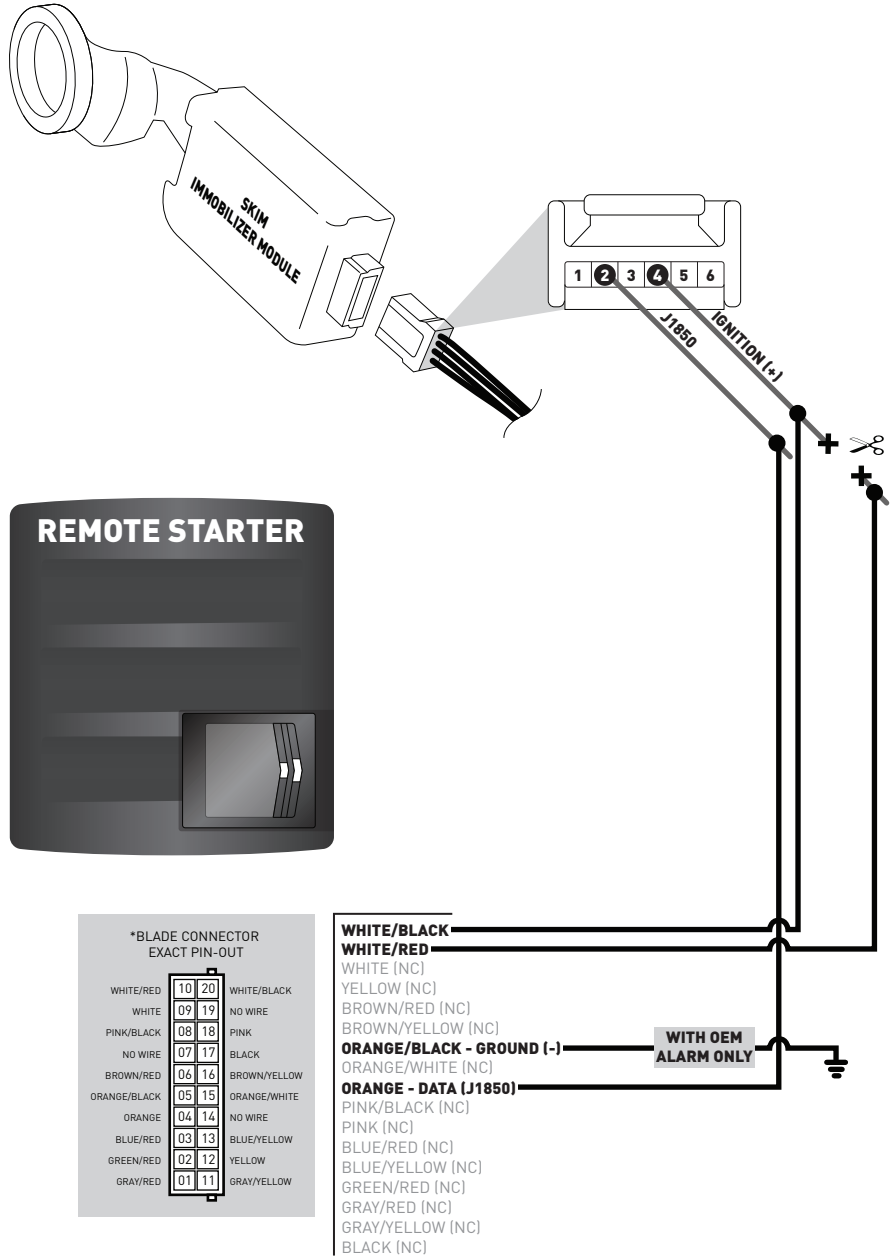

TYPE 2 - WIRE CROSS REFERENCE CHART - 1 OF 1

MAKE	MODEL	YEAR	IGNITION	J1850
			WIRE COLOR	WIRE COLOR
CHRYSLER	Pacifica	04-08	Pink/Gray	White/Violet
	Town & Country	04-07	Pink/White	White/Violet
DODGE	Caravan/Grand Caravan	04-07	Pink/White	White/Violet
JEEP	Liberty	05-07	Pink/LtGreen	White/Violet

TYPE 2 - WIRING DIAGRAM

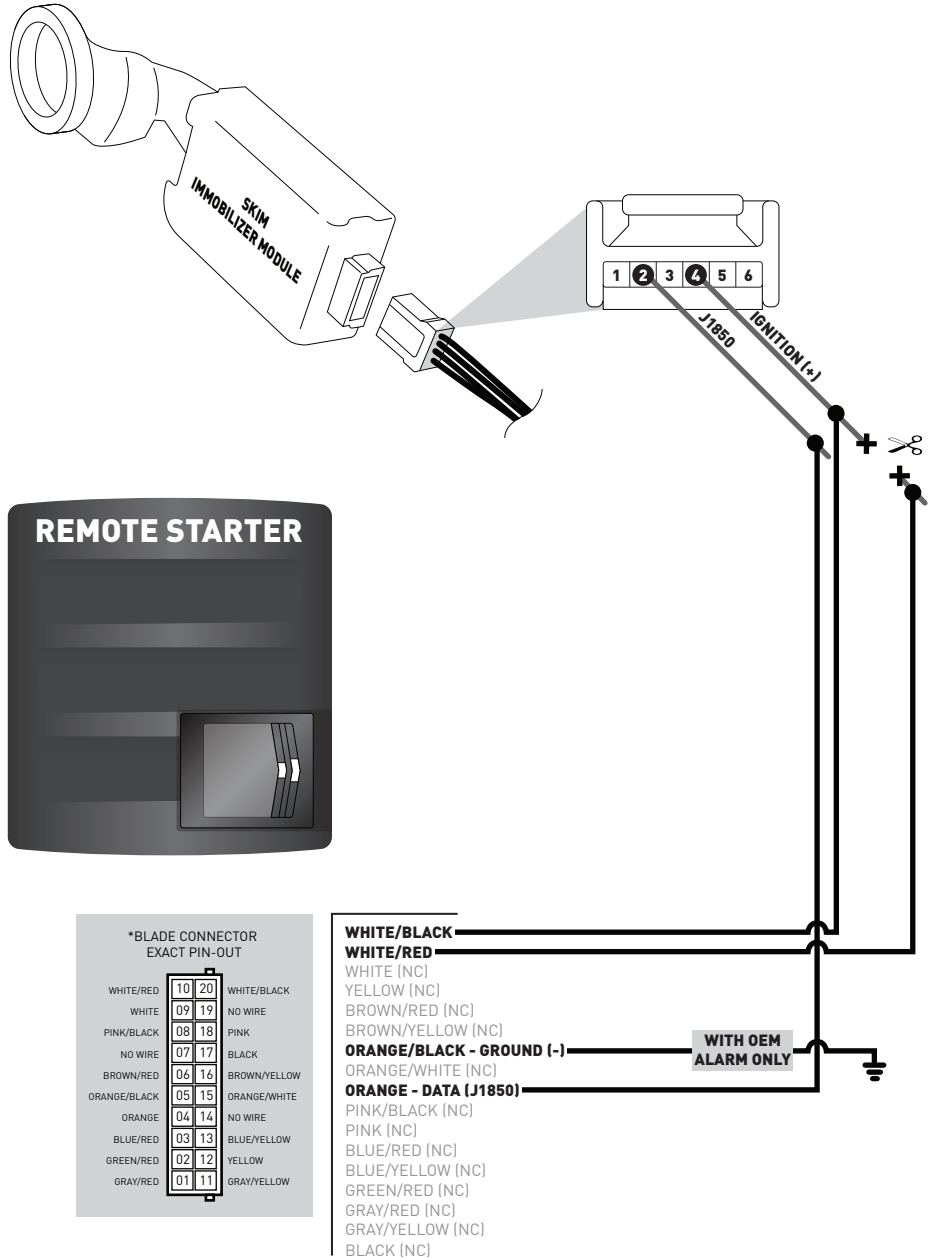

TYPE 3 - COMPONENT LOCATOR

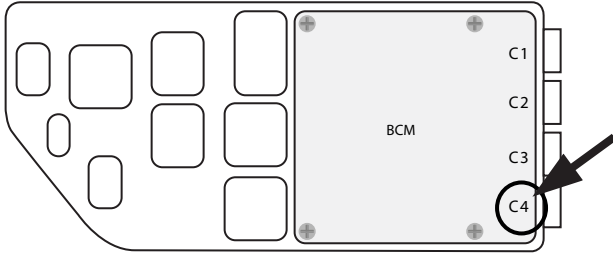

BCM: 300M, CONCORDE, INTREPID

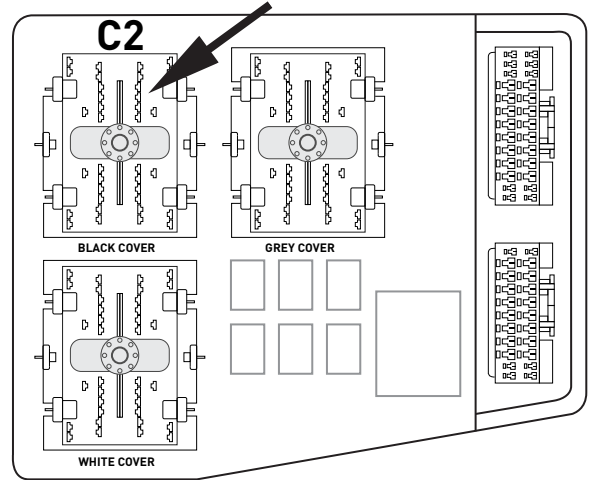

BCM: LIBERTY

TYPE 3 - WIRE CROSS REFERENCE CHART - 1 OF 1

MAKE	MODEL	YEAR	ANALOG DOORLOCK		IGNITION	J1850
			WIRE COLOR	LOCATION	WIRE COLOR	WIRE COLOR
CHRYSLER	300M ¹	99-04	LtGreen/Orange	At BCM, C4 Connector, Pin #13 (See BCM image)	Blue/White	Violet/Yellow
	Concorde ¹	99-04	LtGreen/Orange	At BCM, C4 Connector, Pin #13 (See BCM image)	Blue/White	Violet/Yellow
	LHS ¹	99-01	LtGreen/Orange	At BCM, C4 Connector, Pin #13 (See BCM image)	Blue/White	Violet/Yellow
	Neon ^{1&2}	00-05	LtGreen	Harness coming from driver door	Blue/White	Violet/Yellow
	PT Cruiser ¹	01-05	White/DkGreen	Harness coming from driver door	Blue/Black	Violet/Yellow
	Sebring Convertible ¹	01-06	LtGreen/Orange	At BCM, C4 Connector, Pin #4 or Harness from driver door	Blue/White	Violet/Pink
	Sebring Sedan ¹	01-06	LtGreen/Orange	At BCM, C4 Connector, Pin #4 or Harness from driver door	Blue/White	Violet/Pink
DODGE	Dakota ¹	01-04	LtGreen/Orange	Driver Kick Panel	LtGreen/Black	Violet/Yellow
	Durango ¹	01-03	LtGreen/Orange	Driver Kick Panel	LtGreen/Black	Violet/Yellow
	Intrepid ¹	99-04	LtGreen/Orange	At BCM, C4 Connector, Pin #13 (See BCM image)	Blue/White	Violet/Yellow
	Ram Pickup ²	02-03	White/LtGreen	Driver Kick Panel	LtGreen/Black	Violet/White
	Ram Pickup ¹	02-03	LtGreen/Orange	Driver Kick Panel	LtGreen/Black	Violet/White
	Ram Pickup ²	04-05	Purple/DkGreen	Driver Kick Panel	Pink/Gray	White/Violet
	Ram Pickup ¹	04-05	Purple/LtBlue	Driver Kick Panel	Pink/Gray	White/Violet
	SRT 4 ^{1&2}	03-05	LtGreen	Harness coming from driver door	Blue/White	Violet/Yellow
	Stratus Sedan ¹	01-06	LtGreen/Orange	At BCM, C4 Connector, Pin #4 or Harness from driver door	Blue/White	Violet/Pink
SX 2.0 ^{1&2}	03-05	LtGreen	Harness coming from driver door	Blue/White	Violet/Yellow	
JEEP	Liberty ^{1&2}	02-04	Pink/Violet	At BCM, C2 Connector, Pin #20 (See BCM image)	Blue	Yellow/Violet or Violet/Black
PLYMOUTH	Neon ^{1&2}	00-01	LtGreen	Harness coming from driver door	Blue/White	Violet/Yellow

¹ With OEM Alarm

² Without OEM Alarm

TYPE 3 - WIRING DIAGRAM

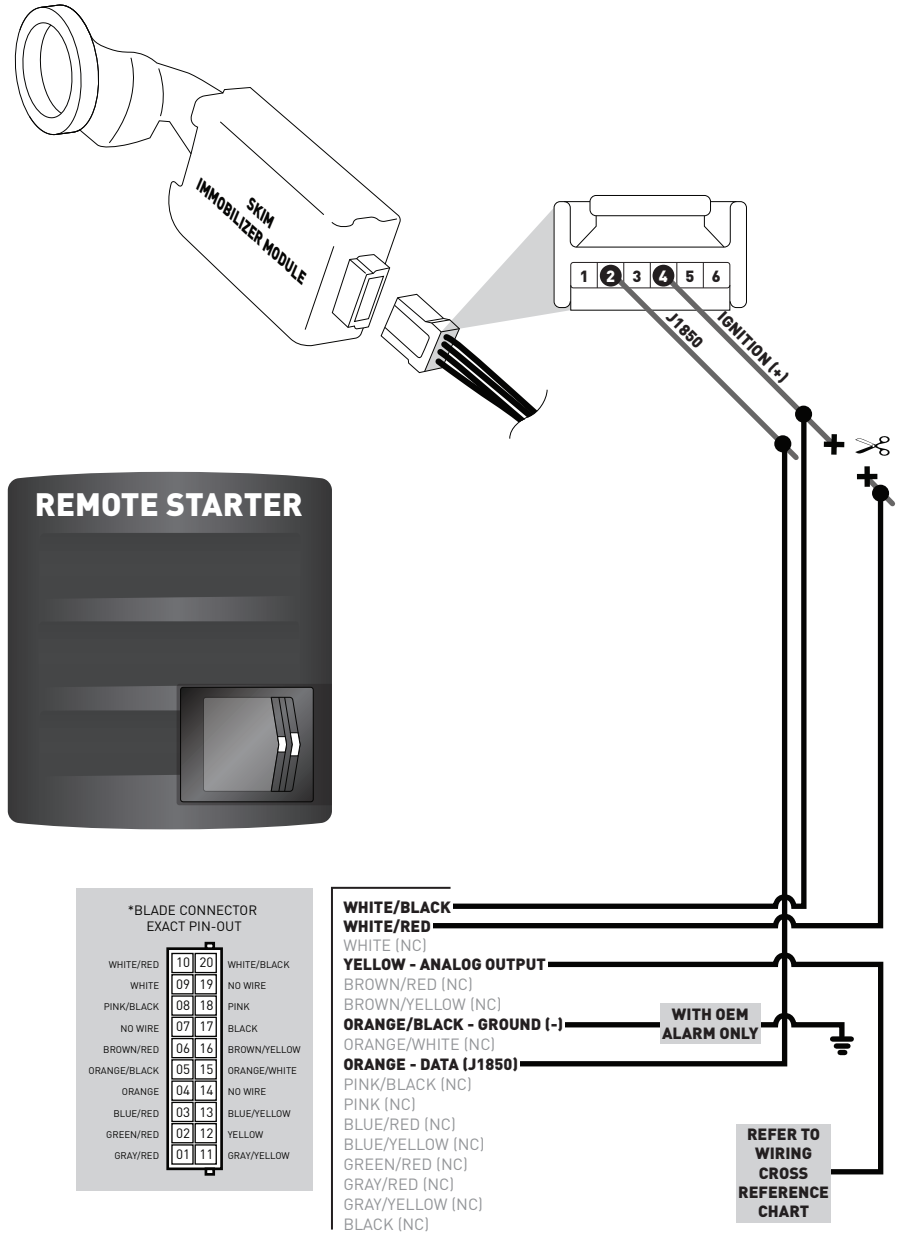

TYPE 4 - WIRING DIAGRAM

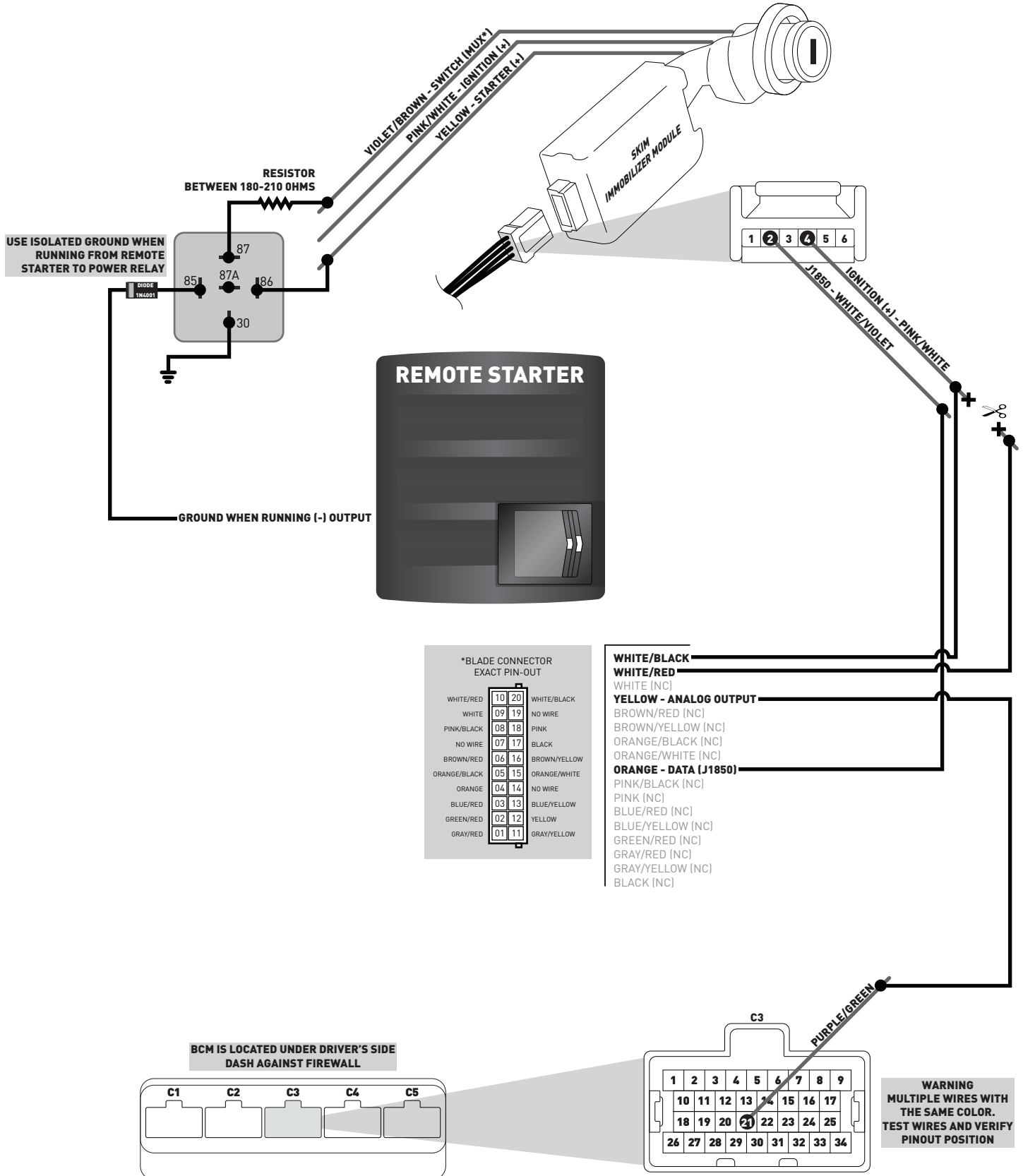

TYPE 5 - WIRING DIAGRAM

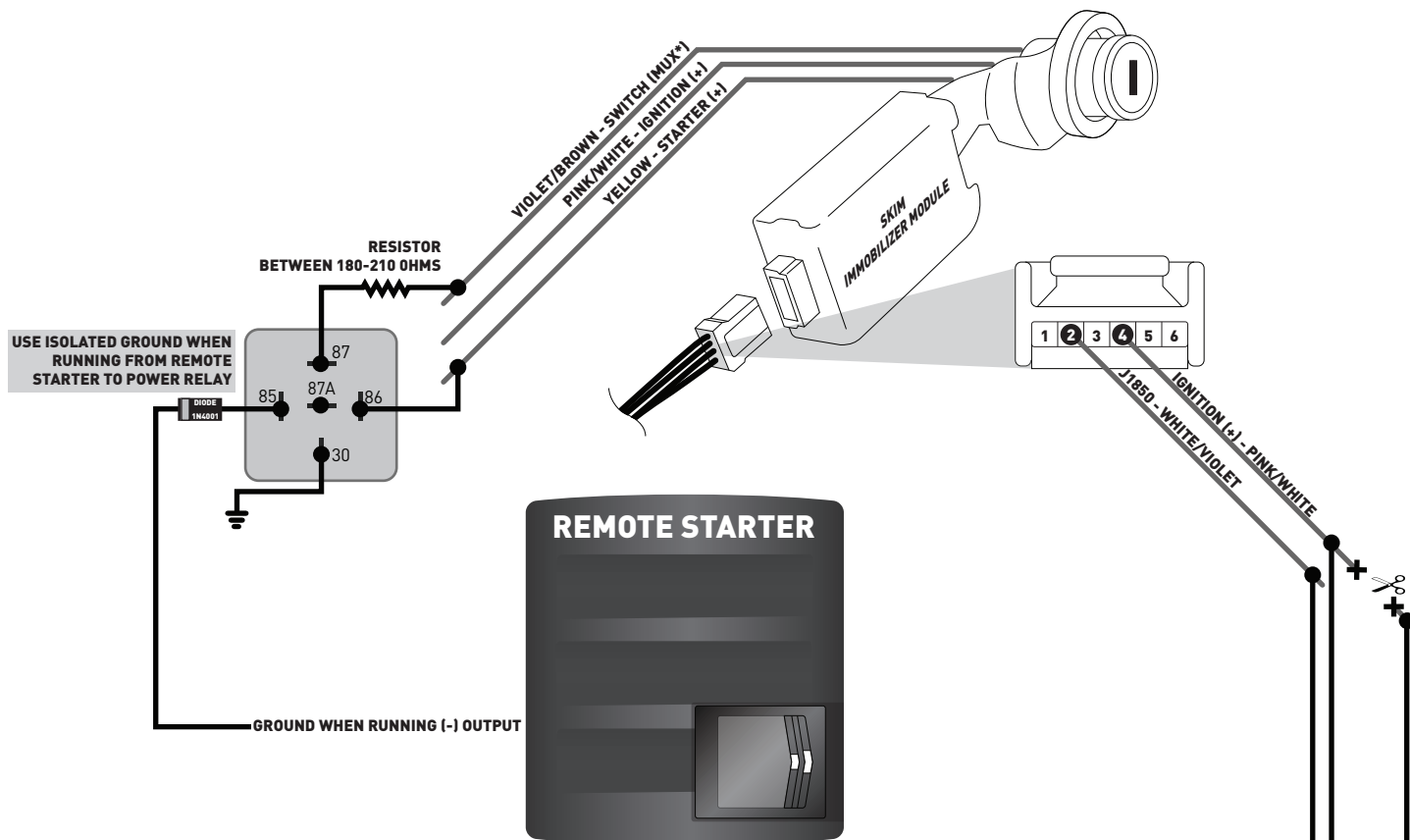

*BLADE CONNECTOR EXACT PIN-OUT

WHITE/RED	10	20	WHITE/BLACK
WHITE	09	19	NO WIRE
PINK/BLACK	08	18	PINK
NO WIRE	07	17	BLACK
BROWN/RED	06	16	BROWN/YELLOW
ORANGE/BLACK	05	15	ORANGE/WHITE
ORANGE	04	14	NO WIRE
BLUE/RED	03	13	BLUE/YELLOW
GREEN/RED	02	12	YELLOW
GRAY/RED	01	11	GRAY/YELLOW

- WHITE/BLACK
- WHITE/RED
- WHITE (NC)
- YELLOW - ANALOG OUTPUT
- BROWN/RED (NC)
- BROWN/YELLOW (NC)
- ORANGE/BLACK - GROUND (-)
- ORANGE/WHITE (NC)
- ORANGE - DATA (J1850)
- PINK/BLACK (NC)
- PINK (NC)
- BLUE/RED (NC)
- BLUE/YELLOW (NC)
- GREEN/RED (NC)
- GRAY/RED (NC)
- GRAY/YELLOW (NC)
- BLACK (NC)

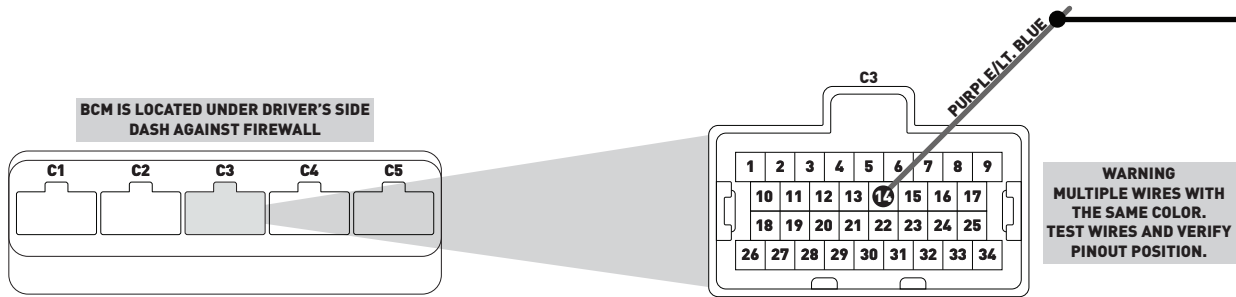

TYPE 6 - WIRING DIAGRAM

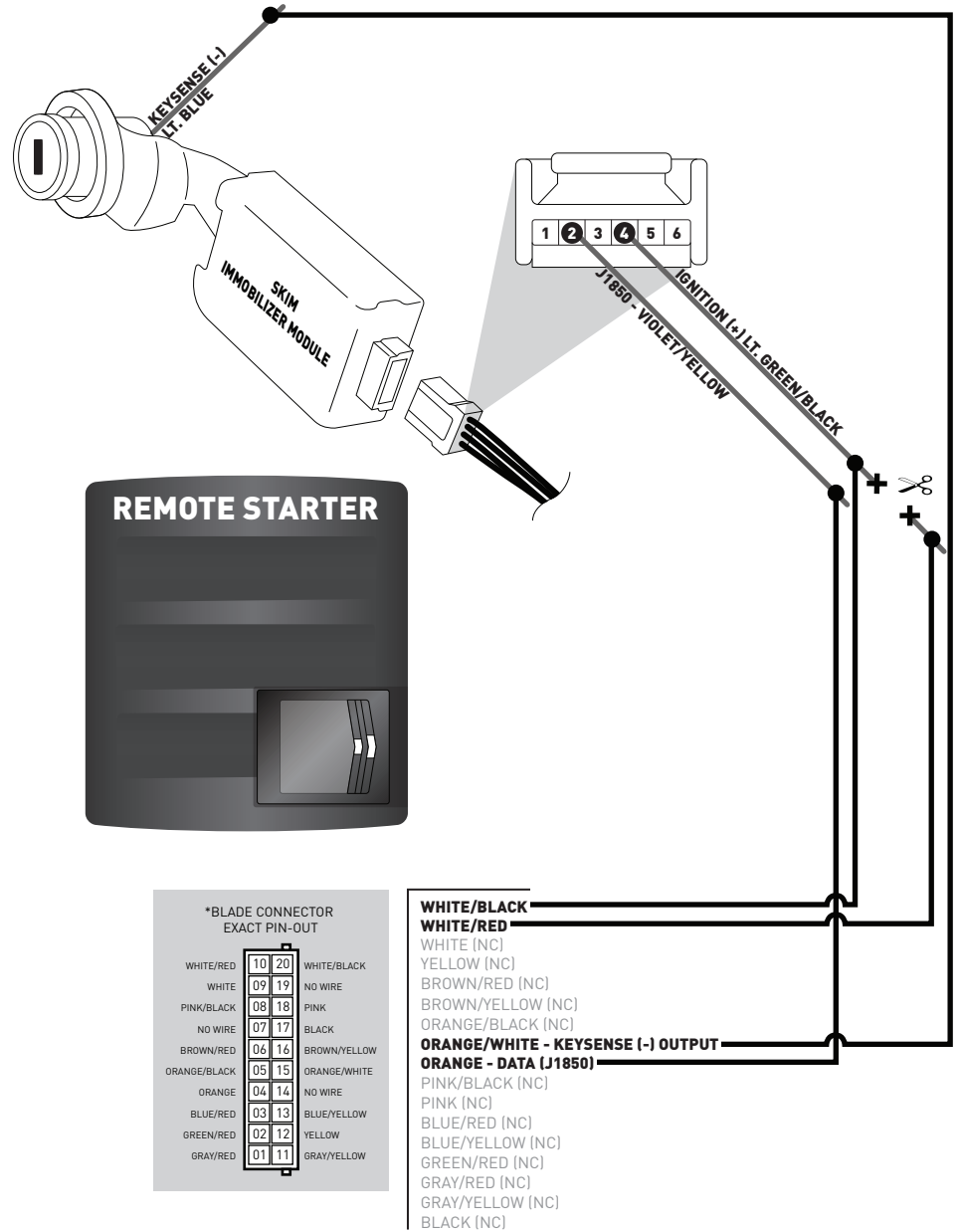

CARTRIDGE INSTALLATION

1

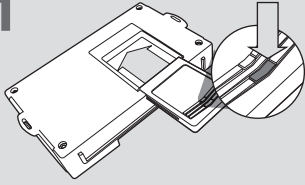

Slide cartridge into unit. Notice button under LED.

2

Ready for Module Programming Procedure.

MODULE PROGRAMMING PROCEDURE

1

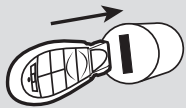

Insert key into ignition.

2

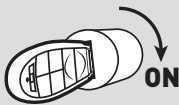

Turn key to ON position.

3

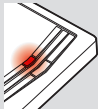

LED will turn solid RED.

4

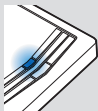

Wait, it may take up to **20 seconds**. LED will turn solid BLUE then will turn OFF.

5

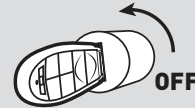

Turn key to OFF position.

6

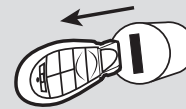

Remove key.

7

Module Programming Procedure completed.

IDENTIFY VEHICLE YEAR

1 Locate the Vehicle Identification Number (VIN), identify the 10th character then match it to its corresponding year.



A	1980	L	1990	Y	2000	A	2010
B	1981	M	1991	1	2001	B	2011
C	1982	N	1992	2	2002	C	2012
D	1983	P	1993	3	2003	D	2013
E	1984	R	1994	4	2004	E	2014
F	1985	S	1995	5	2005	F	2015
G	1986	T	1996	6	2006	G	2016
H	1987	V	1997	7	2007	H	2017
J	1988	W	1998	8	2008	J	2018
K	1989	X	1999	9	2009	K	2019

MODULE DIAGNOSTICS

LED STATUS	DIAGNOSTICS		
	DURING PROGRAMMING	DURING REMOTE START	WITH IGNITION OFF
Flashing RED	Missing/wrong information from firmware or vehicle	Incorrectly programmed	Incorrectly programmed or connected
Solid RED	Waiting for more vehicle information	Incorrectly programmed	Not programmed waiting for more vehicle information
Flashing BLUE	Additional steps required to complete programming	Correctly programmed and operational	False ground when running status from remote starter
Solid BLUE then OFF	Correctly programmed	Reset in progress	Reset in progress
OFF	No activity or already programmed	Invalid ground when running status from remote starter	At rest and ready for a remote start sequence

FACTORY RESET PROCEDURE

- DISCONNECT** cartridge from remote starter.
- PRESS AND HOLD** programming button while re-connecting cartridge to remote starter.

- LED will flash red. Immediately **RELEASE** programming button.
- LED will turn solid red for 2 seconds.
RESET COMPLETED.
- RECONNECT** all connectors. Repeat programming procedure.

! Failure to follow procedure may result with a DTC or a CHECK ENGINE error message.